

Rear Wheel Socket

8534M

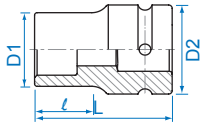

- 4 points
- DIN 3121



KT NO.	SQ	D1 mm	D2 mm	ℓ mm	L mm	g	kg	1/24
853417M	17	38.0	54	23.5	76	658	1 / 24	
853419M	19	43.0	54	23.5	76	717	1 / 24	
853421M	21	47.0	54	23.5	76	773	1 / 24	

8545M



- DIN 3121
- 17SQ x35MM Isuzu, Mitsubishi, Nissan, Mazda
- 19SQ x41MM Mazda
- 20SQ x38MM Hino, Toyota, Daihatsu
- 20SQ x41MM Hino, Toyota, Daihatsu
- 21SQ x41MM Scania, Isuzu, Hino, Mitsubishi, Nissan



Use for

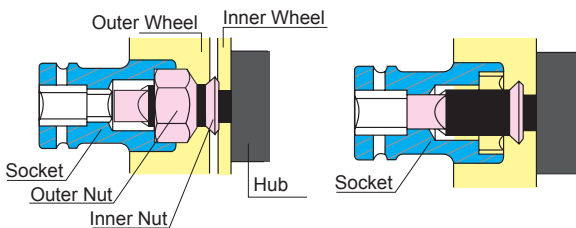
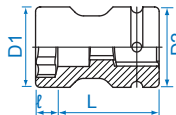

The wheel nut socket fits onto both outer nut and inner nut

KT NO.	SQ	mm	D1 mm	D2 mm	ℓ mm	L mm	g	kg	1/24
85451735M	17 x 35		54	54	13	83	857	1 / 24	
85451941M	19 x 41		55	54	14	87	924	1 / 24	
85452038M	20 x 38		58	54	14	83	796	1 / 24	
85452041M	20 x 41		58	54	14	87	1086	1 / 24	
85452141M	21 x 41		58	54	14	87	1017	1 / 24	

Impact Bit Socket

1954



- Hex bit & bit holder
- DIN 3121



1954



809622M

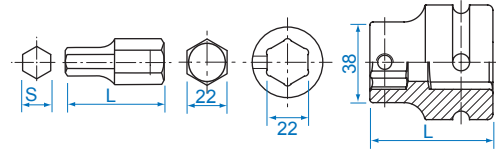

KT NO.	S mm	L mm	Max. torq N-m	g	kg	1/24
195419H	H19	54.5	1577	140	12 / 120	
195422H	H22	54.5	2436	162	12 / 120	
195424H	H24	54.5	2436	176	10 / 100	
195427H	H27	54.5	2436	200	10 / 100	
195430H	H30	54.5	2436	232	6 / 60	
195432H	H32	54.5	2436	243	6 / 60	
809622M	22	58.0	-	547	1 / 24	

809622MxxH



- Hexagon head
- DIN 3121

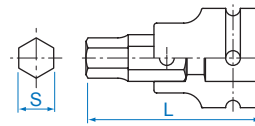

KT NO.	S mm	mm	L (mm)	Max. torq N-m	g	kg	1/24
809622M19H	H19	22	93	1577	896	1 / 10	
809622M22H	H22	22	93	2436	918	1 / 10	
809622M24H	H24	22	93	2436	932	1 / 10	
809622M27H	H27	22	93	2436	956	1 / 10	
809622M30H	H30	22	93	2436	988	1 / 10	
809622M32H	H32	22	93	2436	999	1 / 10	

8015M

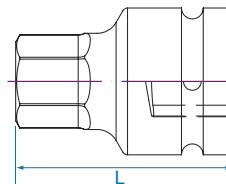

KT NO.	mm	L mm	g	kg	1/24
801521M	H21	80	710		1 / 24
801522M	H22	80	720		1 / 24
801524M	H24	80	741		1 / 24
801527M	H27	80	776		1 / 24
801530M	H30	80	820		1 / 24
801532M	H32	80	851		1 / 24
801536M	H36	80	921		1 / 24