

SAAB

Diesel Engine Setting & locking Set

9AT2005E

- The set includes crankshaft locking tool, camshaft setting tools(pair) and a tensioner locking pin
- Suitable for Saab, Vauxhall / Opel engine
- Use to set and lock engines timing



5
PC.

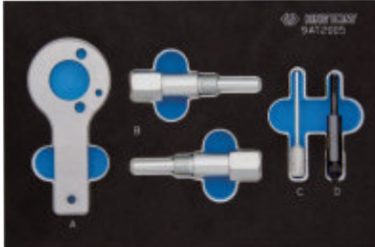

CONTENTS :

- A&D - crankshaft locking tools
- B - camshaft setting tool (pair)
- C - tensioner locking pin

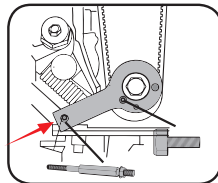
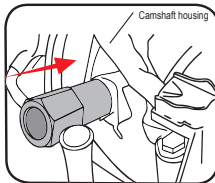

1295.0 1 / 10

MODEL: Diesel 2.2D TID
9-3 (98-04), 9-5 (02-06)

ENGINE CODE: Diesel 2.2D TID
Z19DT / Z19DTH

SUZUKI

Petrol Engine Setting & Locking Set

9AT1004E

- The set includes camshaft setting plate, crankshaft locking pin, chain tensioner locking pin and also camshaft sensor aligning bracket
- The bracket is used to position the timing sensor disc on the inlet camshaft



4
PC.

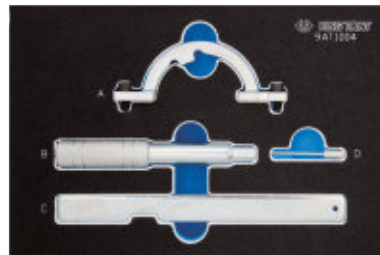

CONTENTS :

- A - camshaft sensor aligning bracket
- B - crankshaft locking pin
- C - camshaft locking tool
- D - tensioner retaining pin

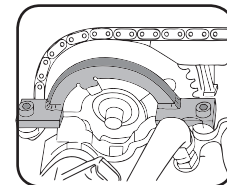
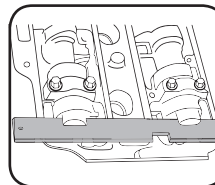

1316.5 1 / 10

MODEL: Petrol 1.0 / 1.2 (Chain)
Wagon R+ (05-08)

ENGINE CODE: Petrol 1.0 / 1.2 (Chain)
Z10XEP
Z12XEP

SUZUKI

Diesel Engine Setting & Locking Set

9AT2004E

- The set includes flywheel locking pin, camshaft setting tools, tensioner locking pin
- Use to retain timing position only. DO NOT use them to hold camshafts in position while releasing or tightening the sprocket bolts

4
PC.



1100.5 1 / 10

MODEL: Diesel 1.3 DDiS (Belt)
Swift (04-09)
Ignis (03-09)
Wagon R+ (03-08)

ENGINE CODE: Diesel 1.3 DDiS (Belt)
Z13DT



CONTENTS :

- A- camshaft setting tool set (pair)
- B- flywheel locking pin
- C- tensioner retaining pin

