

BMW

Diesel Engine 2.0 / 3.0 Timing Set



9AT2007E

- The set includes camshaft setting plate, tensioner retaining pin set and flywheel locking pin
- Suitable for BMW 2.0 and 3.0 liters common rail diesel engines in BMW 3, 5 & 7 Series, X5, Land Rover Freelander, Range Rover, Rover 75, Vauxhall / Opel
- Use to check and adjust the timing position of camshaft and TDC position of crankshaft

7
PC.



1752.5 / 1 / 10

MODEL: 118d E87 (03-07), 120d E87 (03-07)
318d / td E46 / E90 / 91(00-08)
320d / td E46 / E90 / 91(97-08)
325d E90 / 91 / 92 / 93 (06-09)
330d / xd / cd E46 / E90 / 91 / 92 / 93 (98-08)
335d E90 / 91 / 92 (06-09)
520d E39 / E60 / 61 (99-09)
525d / xd E39 / E60 / 61 (99-09)
530d / xd E39 / E60 / 61 (98-09)
535d E60 / 61 (04-09), 635d E63 / 64 (04-09)
730d / Ld E38 / E65 / 66 (98-08)
X3 2.0d E83 (03-07), X3 3.0d / sd E83 (03-09)
X5 3.0d E53 / E70 (00-09)

ENGINE: M47 / M57/ M47TU / M57TU / M47T2 / M57T2
20 4D 1, 20 4D 4, 25 6D 1, 25 6D 2
CODE: 30 6D 1, 30 6D 2, 30 6D 3, 30 6D 4
30 6D 5

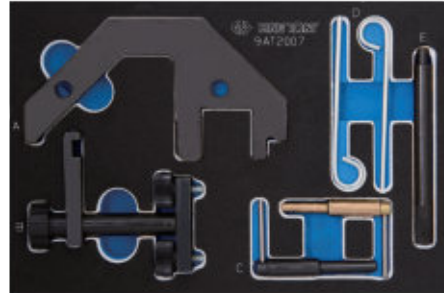

CONTENTS :

- A – camshaft setting plate
- B – camshaft plate locking tool
- C – TDC timing pin
- D – tensioner retaining pin set (pair)
- E – flywheel locking pin

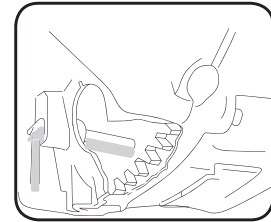
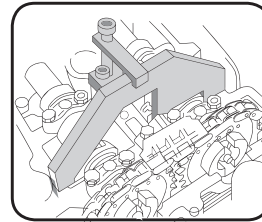

BMW

Petrol Engine Timing Setting & Locking Set



9AT1206E

- The set includes VANOS alignment plate, camshaft setting tools, flywheel locking pin and timing chain tensioner pre-load tool
- Suitable for 1.6 BMW, 4 cylinder twin camshaft 16v and chain driven petrol engines with VANOS
- Use to check and adjust engine timing

6
PC.



2657.0 / 1 / 5

MODEL: 116i. E81 E87 (03-09)
316i. E46 / E90 (01-08)
316Ci. E46 (01-06)
316ti. E46 (01-05)

ENGINE: N40 / N45 / N45T
CODE: B16, B16A, B16AC



CONTENTS :

- A - VANOS alignment plate
- B - camshaft setting plate (inlet)
- C - timing chain tensioner pre-load tool
- D - camshaft setting plate (exhaust)
- E - camshaft setting plate securing screw
- F - flywheel locking pin

