

# Star Socket



KT No. & D1

## 3375M

3/8"

- Chrome vanadium steel
- Polished, chrome plated
- DIN 3120

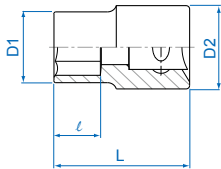

KT NO.	Size	D1 mm	D2 mm	ℓ mm	L mm	⚖️	📦
337504M	E4	6.0	16.8	3.6	28	18	12 / 360
337505M	E5	7.0	16.8	4.0	28	19	12 / 360
337506M	E6	8.0	16.8	5.0	28	20	12 / 360
337507M	E7	8.9	16.8	6.0	28	21	12 / 360
337508M	E8	10.0	16.8	6.5	28	21	12 / 360
337510M	E10	12.0	16.8	7.0	28	22	12 / 360
337511M	E11	12.8	16.8	8.0	28	23	12 / 360
337512M	E12	14.3	16.8	9.0	28	25	12 / 360
337514M	E14	15.9	17.8	9.5	28	29	12 / 360
337516M	E16	18.0	19.8	10.5	28	39	10 / 300
337518M	E18	20.0	21.8	11.0	28	50	10 / 300

## 3275M

3/8"

- Chrome vanadium steel
- Polished, chrome plated
- DIN 3120

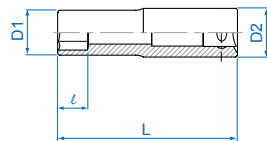

KT NO.	Size	D1 mm	D2 mm	ℓ mm	L mm	⚖️	📦
327504M	E4	6.0	16.8	3.6	63	46	20 / 400
327505M	E5	7.0	16.8	4.0	63	48	20 / 400
327506M	E6	8.0	16.8	5.0	63	49	20 / 400
327507M	E7	8.9	16.8	6.0	63	51	20 / 320
327508M	E8	10.0	16.8	6.5	63	53	20 / 320
327510M	E10	12.0	16.8	7.0	63	57	18 / 288
327511M	E11	12.8	16.8	8.0	63	59	18 / 288
327512M	E12	14.3	16.8	9.0	63	62	18 / 288
327514M	E14	15.9	16.8	9.5	63	68	15 / 240
327516M	E16	17.8	17.8	10.5	63	85	15 / 240
327518M	E18	19.8	19.8	11.0	63	90	10 / 160

# Thin Wall Deep Socket

- Chrome vanadium alloy steel
- Polished, chrome plated
- 4 ball retaining grooves



KT No. & D1



## 3215M

3/8"

- Specifically for heat plug, glow plug

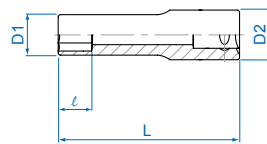

Thin walled design (D1)



KT NO.	mm	D1 mm	D2 mm	ℓ mm	L mm	⚖️	📦
321510M	10	13.0	17.8	12.0	65	65	20 / 240
321512M	12	15.0	17.8	15.0	65	57	20 / 240