

# Deep Impact Socket

- Material - chrome molybdenum alloy steel
- Finishing - phosphate sunk

## 6435M

3/4"

• DIN 3121

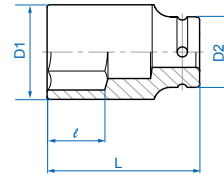

KT NO.	Ø mm	D1 mm	D2 mm	ℓ mm	L mm	⚖️	📦
643519M	19	32	44	16	90	558	1 / 24
643521M	21	35	44	18	90	592	1 / 24
643522M	22	36	44	18	90	607	1 / 24
643523M	23	37	44	23	90	607	1 / 24
643524M	24	38	44	23	90	626	1 / 24
643525M	25	40	44	25	90	661	1 / 24
643526M	26	40	44	25	90	623	1 / 24
643527M	27	42	44	27	90	623	1 / 24
643528M	28	44	44	27	90	670	1 / 24
643529M	29	45	44	27	90	670	1 / 24
643530M	30	46	44	27	90	691	1 / 24
643532M	32	48	44	30	90	728	1 / 24
643533M	33	50	44	30	90	790	1 / 24
643534M	34	51	44	32	90	794	1 / 24

KT NO.	Ø mm	D1 mm	D2 mm	ℓ mm	L mm	⚖️	📦
643535M	35	52	44	32	90	803	1 / 24
643536M	36	53	44	32	90	809	1 / 24
643538M	38	56	44	34	90	882	1 / 24
643540M	40	58	44	34	90	928	1 / 24
643541M	41	59	44	34	90	938	1 / 24
643542M	42	61	44	36	95	1074	1 / 24
643543M	43	62	44	38	95	1103	1 / 10
643544M	44	64	44	38	95	1180	1 / 10
643546M	46	66	44	38	95	1210	1 / 10
643548M	48	68	44	40	95	1391	1 / 10
643550M	50	71	44	40	95	1479	1 / 10
643555M	55	77	54	45	100	1810	1 / 10
643560M	60	84.5	54	50	100	2010	1 / 6
643565M	65	86.5	54	54	100	1990	1 / 6

## 6435S

3/4"

• ANSI/ASME B107.2

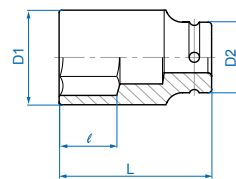

KT NO.	Ø inch	D1 mm	D2 mm	ℓ mm	L mm	⚖️	📦
643524S	3/4	32	38	16	90	455	1 / 24
643526S	13/16	35	38	18	90	490	1 / 24
643528S	7/8	36	38	18	90	495	1 / 24
643530S	15/16	37	38	23	90	495	1 / 24
643532S	1	38	38	25	90	500	1 / 24
643534S	1-1/16	42	44	27	90	624	1 / 24
643536S	1-1/8	44.7	44	27	90	680	1 / 24
643538S	1-3/16	46	44	27	90	684	1 / 24
643540S	1-1/4	48	44	30	90	733	1 / 24
643542S	1-5/16	50	44	30	90	789	1 / 24
643544S	1-3/8	52	44	32	90	804	1 / 24

KT NO.	Ø inch	D1 mm	D2 mm	ℓ mm	L mm	⚖️	📦
643546S	1-7/16	54	44	32	90	844	1 / 24
643548S	1-1/2	56	44	34	90	871	1 / 24
643550S	1-9/16	58	44	34	90	928	1 / 24
643552S	1-5/8	59	44	34	90	941	1 / 24
643554S	1-11/16	63.5	44	38	95	1111	1 / 10
643556S	1-3/4	64	44	38	95	1168	1 / 10
643558S	1-13/16	66	44	38	95	1241	1 / 10
643560S	1-7/8	68	54	40	95	1397	1 / 10
643562S	1-15/16	70	54	40	95	1448	1 / 10
643564S	2	72	54	40	95	1521	1 / 10

