



ENGINE STAND  
Capacity: 1000LBS

NO.9TY135-100A-B



**WARNING :**  
Before using this appliance,  
read this Operator's Manual  
and follow all its Safety Rules  
and Operating Instructions.

Enjoy your work



**SAFETY INSTRUCTIONS**

Study understand arc follow all warning and instructions before using this stand. Do not exceed rated capacity. Use only on nard, level surfaces capable of sustaining the load.Lock mounting plate-rotating mechanism before applying the load. Lock mounting plate-rotating mechanism before applying the load.Be sure engine is centered and secured to mounting plate before applying load to stand.Off center loads may make the load and handle rotate in either direction hen the rotational locking is released. Release the rotational locking device slowly and carefully.Do not attempt to move the loaded stand across a floor having cracks or other obstacles that could impede movement, never work directly under a supported load.Visually inspect stand for damage before use. Check for cracked welds, bent metal and loose, damaged or missing pats. Use only attachment and adapters supplled and approved by the manufacturer. Do not make any alterations to this product.Failure to heed these warnings may result in personal injury, property damage and/or death. This engine stand is a device used to mount an automotive type of engine when removed from a vehicle. This device is designed to provide access to the engine for servicing and/or rebuilding. The stand incorporates a locking, rotating mounting plate so that the user can turn the engine for ease of access. The stand also incorporates wheels and casters to allow mobility across a smooth, flat surface

**OPERATION**

Before applying load

- With the mounting arms loose from the mounting plate (but not removed) bolt the mounting arms to the rear of the engine using the bell housing mounting bolts (bolts not supplied).
- Make sure the engine is centered and straight on the mounting plate, then tighten the mounting arms to the engine, and the mounting arms to the mounting plate
- After making sure all connections are tight, SLOWLY lower the hoist, transferring load to the stand, To remove an engine from the stand

To remove an engine from the stand Attach the hoist to the engine using a sling or similar device.After the hoist and sling are secure to the engine, raise the hoist, taking the load off of the stand.The mounting bolts can be removed freeing the stand from the engine

**INPECTION**

A complete visual inspection must be made before each use of the stand.Check for broken or cracked wells, excessive rust, and loose, damaged or missing parts. Check that the wheels and casters operate smoothly. Also check that the mounting plate rotation lock works properly before applying the load. If any problems as described above or otherwise are found, remove the stand from service. Also inspect the label; making sure that it is legible, and securely attached to the stand. If not, call the manufacturer's parts department for a replacement.If the stand has been, or is believed to have been subjected to an abnormal load or shock load, you must inspect the stand immediately before putting the stand into or resuming service.

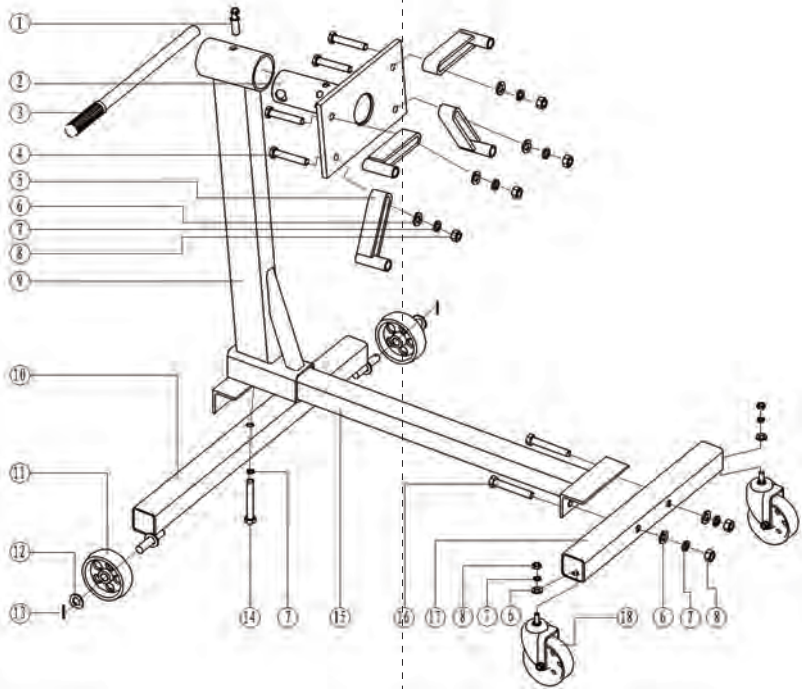

| Item | Name             | Qty. |
|------|------------------|------|
| 01   | Lock Pin         | 1    |
| 02   | Head Assembly    | 1    |
| 03   | Handle           | 1    |
| 04   | Bolt M12x65      | 4    |
| 05   | Mounting Arms    | 4    |
| 06   | Washer 12        | 8    |
| 07   | Spring Washer 12 | 9    |
| 08   | Nut M12          | 8    |
| 09   | Mast Assembly    | 1    |
| 10   | Beam             | 1    |
| 11   | Wheel            | 2    |
| 12   | Washer 14        | 2    |
| 13   | Pin 2x22         | 2    |
| 14   | Bolt M12x80      | 1    |
| 15   | Cross Member     | 1    |
| 16   | Bolt M12x70      | 2    |
| 17   | Front Leg        | 1    |
| 18   | 3"Caster         | 2    |