

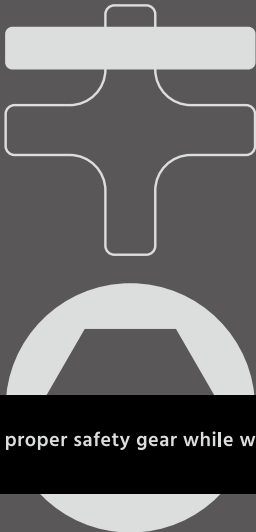

# KING TONY



Please wear proper safety gear while working.





**KING TONY**

# ENGINE CRANE OPERATION MANUAL

**2  
TON**



**NO.9TY1342-02A-B**

## SAFETY INSTRUCTIONS

- Study, understand, and follow operation manual and safety precautions before using this device.
- Failure to heed these warning may result in damage to crane and /or resulting in personal injury or property damage.
- Always use crane in pairs on a hard level surface capable of sustaining the load.
- Do not overload the crane beyond it's rate capacity of each specified boom position.
- Move load slowly and smoothly to avoid uncontrolled swinging and drop suddenly during transport.
- Load and boom must in lowest possible position before removing.
- No any alteration shall be made to the engine crane.
- Visually inspect device for damage before each use.

## OPERATION

Front legs must always be locked in the down position before applying a load and raising the boom (figure 1 & 2).

- Before moving the crane, the brake of rear caster should be in released position.
- When the crane is still, the brake should be in tightened position.
- Boom must be in the fully lowered position before raising legs and should be locked in place (figure 3).

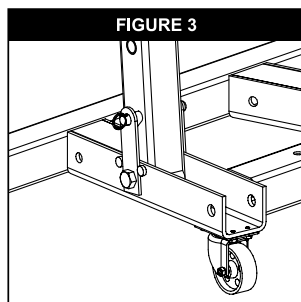
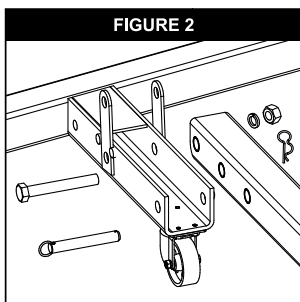
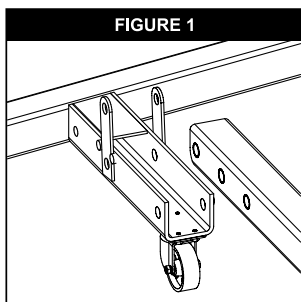

## WARNING

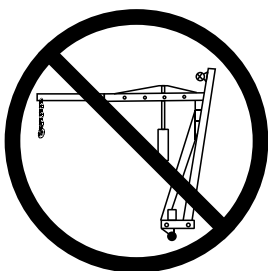
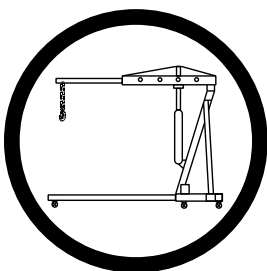

# ASSEMBLY AND PART LIST

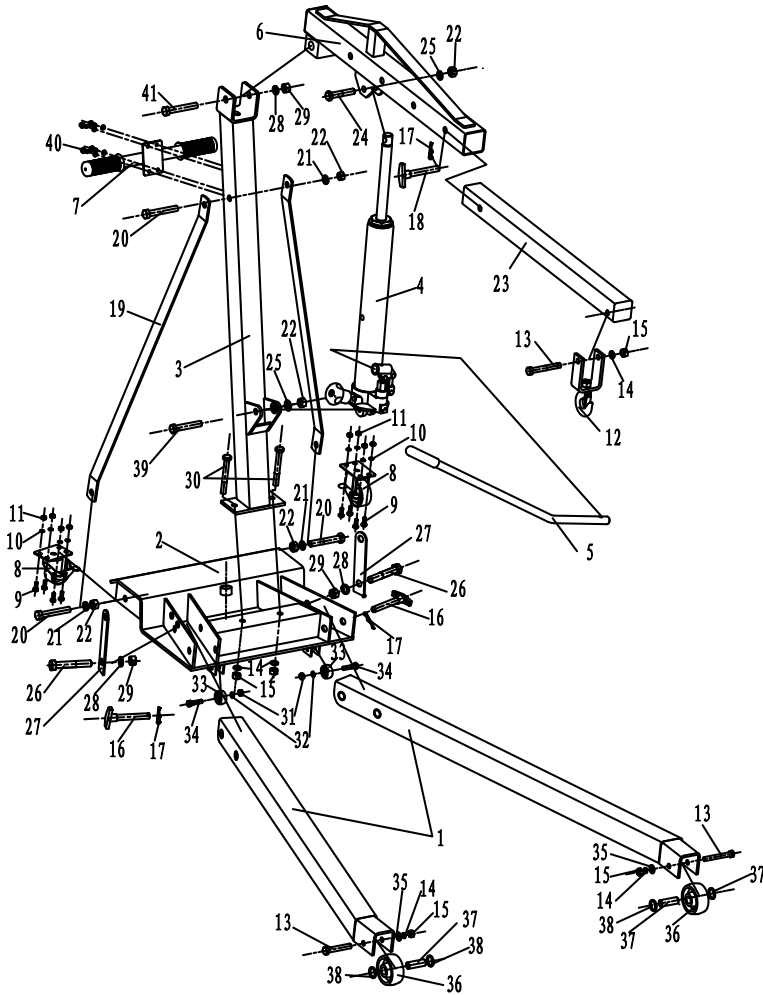

Part	Description	Qty
1	Leg	2
2	Base	1
3	Upright mast	1
4	Hydraulic ram	1
5	Pump handle	1
6	Boom	1
7	Handle	1
8	Swivel caster 3"	2
9	Bolt M8x20	8
10	Spring washer 8	12
11	Nut M8	8
12	Hook	1
13	Bolt M14x90	3
14	Spring washer 14	5
15	Nut M14	5
16	Detent pin	2
17	R-clip	3
18	Boom pin	1
19	Mast brace	2
20	Bolt M16x100	3
21	Spring washer 16	3
22	Nut M16	5
23	Boon extension	1
24	Bolt M16x75	1
25	Washer 16	2
26	Bolt M8x110	2
27	Bracket	2
28	Spring washer 18	3
29	Nut M18	3
30	Bolt M14x110	2
31	Nut M10	2
32	Spring washer 10	2
33	Wheel	2
34	Bolt M10x40	2
35	Washer 14	2
36	Front wheel	2
37	Bushing	2
38	Collar	4
39	Bolt M16x90	1
40	Bolt M8x10	4
41	Bolt M18x110	1