

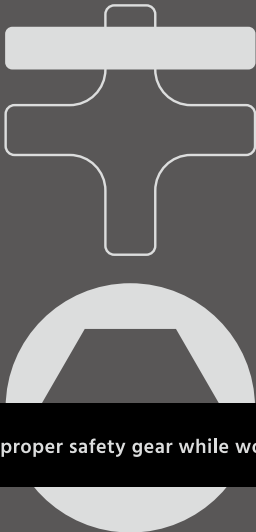

KING TONY



Please wear proper safety gear while working.



service@kingtony.com

www.kingtony.com

899TY1341-01A-B-KT
297x110mm



ENGINE CRANE OPERATION MANUAL

1
TON



CE

SAFETY INSTRUCTIONS

- Study, understand, and follow operation manual and safety precautions before using this device.
- Failure to heed these warning may result in damage to crane and /or resulting in personal injury or property damage.
- Always use stands in pairs on a hard level surface capable of sustaining the load.
- Do not overload the crane beyond it's rate capacity of each specified boom position.
- Move load slowly and smoothly to avoid uncontrolled swinging and drop suddenly during transport.
- Load and boom must in lowest possible position before removing.
- No any alteration shall be made to the engine crane.
- Visually inspect device for damage before each use.

OPERATION

Front legs must always be locked in the down position before applying a load and raising the boom (figure 1 & 2).

- Before moving the crane, the brake of rear caster should be in released position.
- When the hoist is still, the brake should be in tightened position.
- Boom must be in the fully lowered position before raising legs and should be locked in place (figure 3).

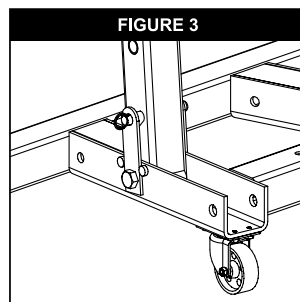
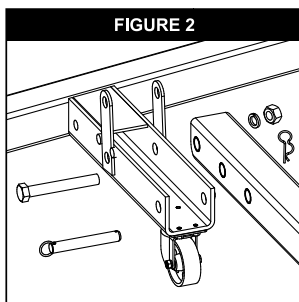
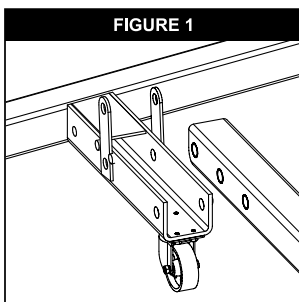

WARNING

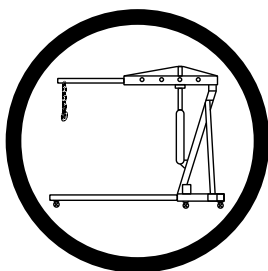

ASSEMBLY AND PART LIST

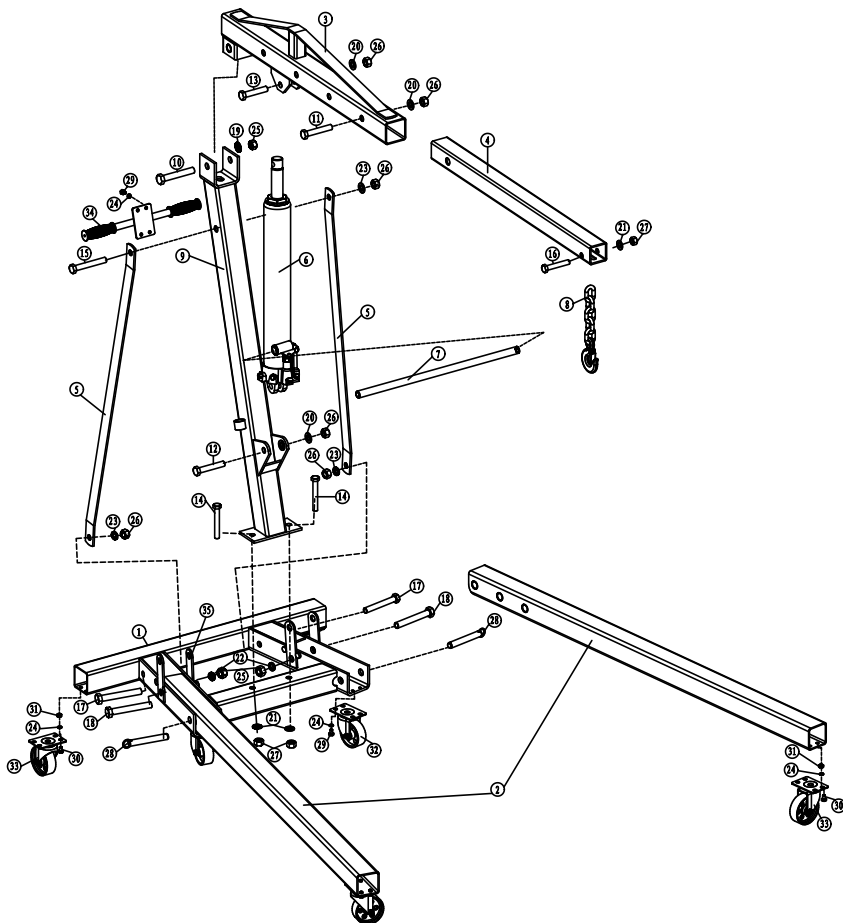

Part	Description	Qty	Part	Description	Qty	Part	Description	Qty
1	Frame base	1	13	Bolt M16x75(8.8)	1	25	Nut 18	3
2	Front leg	2	14	Bolt M14x100	2	26	Nut 16	6
3	Boom	1	15	Bolt M16x110	1	27	Nut 14	3
4	Boom extension	1	16	Bolt M14x75(8.8)	1	28	Frame pin W/Hair pin	2
5	Support strap	2	17	Bolt M16x110	2	29	Bolt M8x12	12
6	Hydraulic ram	1	18	Bolt M18x120	2	30	Bolt M8x20	16
7	Pump handle	1	19	Washer 18	1	31	Nut M8	16
8	Hook chain assembly	1	20	Washer 16	3	32	Swivel caster 3"	2
9	Main support post	1	21	Washer 14	3	33	Swivel caster 3-1/2"	4
10	Bolt M18x110	1	22	Spring washer 18	2	34	Handle	1
11	Bolt M16x90	1	23	Spring washer 16	3	35	Connect plate	4
12	Bolt M16x90(8.8)	1	24	Spring washer 8	8			



KING TONY

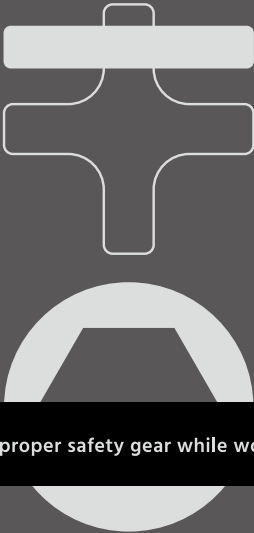

Please wear proper safety gear while working.



service@kingtony.com

www.kingtony.com

899TY1341-02A-B-KT
297x110mm



ENGINE CRANE OPERATION MANUAL

2
TON



CE

SAFETY INSTRUCTIONS

- Study, understand, and follow operation manual and safety precautions before using this device.
- Failure to heed these warning may result in damage to crane and /or resulting in personal injury or property damage.
- Always use stands in pairs on a hard level surface capable of sustaining the load.
- Do not overload the crane beyond it's rate capacity of each specified boom position.
- Move load slowly and smoothly to avoid uncontrolled swinging and drop suddenly during transport.
- Load and boom must in lowest possible position before removing.
- No any alteration shall be made to the engine crane.
- Visually inspect device for damage before each use.

OPERATION

Front legs must always be locked in the down position before applying a load and raising the boom (figure 1 & 2).

- Before moving the crane, the brake of rear caster should be in released position.
- When the hoist is still, the brake should be in tightened position.
- Boom must be in the fully lowered position before raising legs and should be locked in place (figure 3).

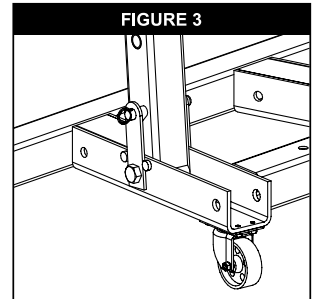
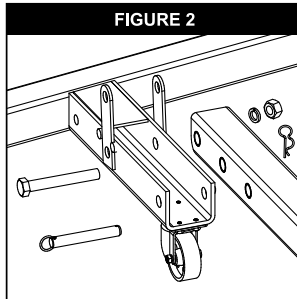
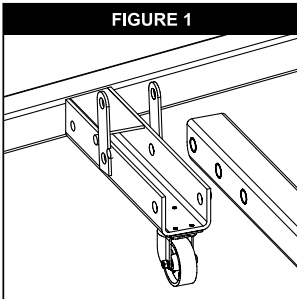

WARNING

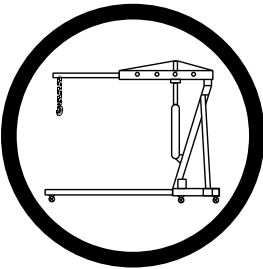

ASSEMBLY AND PART LIST

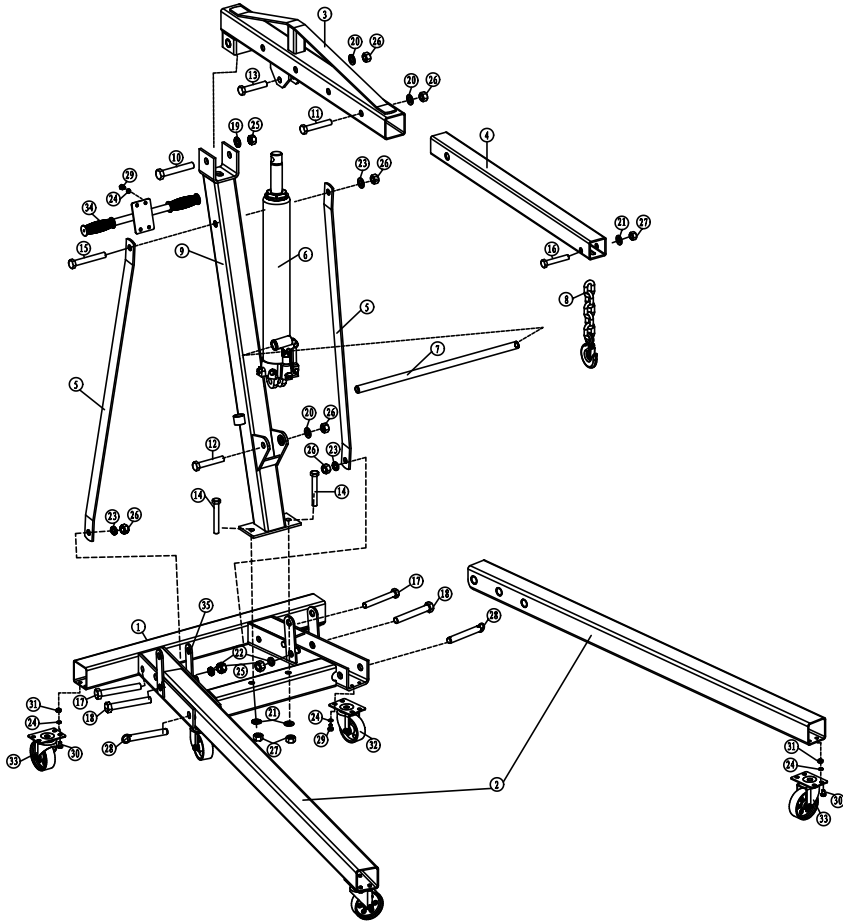

Part	Description	Qty	Part	Description	Qty	Part	Description	Qty
1	Frame base	1	13	Bolt M16x75(8.8)	1	25	Nut 18	3
2	Front leg	2	14	Bolt M14x100	2	26	Nut 16	6
3	Boom	1	15	Bolt M16x110	1	27	Nut 14	3
4	Boom extension	1	16	Bolt M14x75(8.8)	1	28	Frame pin W/Hair pin	2
5	Support strap	2	17	Bolt M16x110	2	29	Bolt M8x12	12
6	Hydraulic ram	1	18	Bolt M18x120	2	30	Bolt M8x20	16
7	Pump handle	1	19	Washer 18	1	31	Nut M8	16
8	Hook chain assembly	1	20	Washer 16	3	32	Swivel caster 3"	2
9	Main support post	1	21	Washer 14	3	33	Swivel caster 3-1/2"	4
10	Bolt M18x110	1	22	Spring washer 18	2	34	Handle	1
11	Bolt M16x90	1	23	Spring washer 16	3	35	Connect plate	4
12	Bolt M16x90(8.8)	1	24	Spring washer 8	8			