

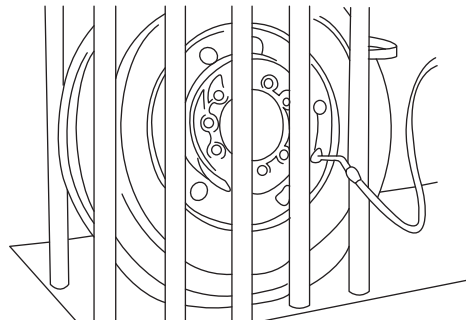

● **GENERAL SAFETY INSTRUCTIONS**

1. Ensure the bead seating tool is in good order and condition before use.
2. Before carrying out maintenance on the unit ensure that the pressure has been vented.
3. Use only authorised attachments and parts. Unauthorised items may be dangerous and will invalidate your warranty.
4. Read the instructions regarding any accessory used with the bead seater.
5. Keep the work area clean and tidy.
6. Clean ,tidy and well lit.
7. Always wear safety glasses and ear defenders when using the bead seater.
8. Place tire/wheel assembly inside safety cage or other suitable restraint.
9. Keep children and unauthorised people away from the working area.
10. **DO NOT** use the bead seater to perform a task for which it is not designed.
11. **DANGER! DO NOT** direct compressed air towards people or animals.
12. **WARNING! Please follow the safety precautions**

- **DO NOT** use the bead seater without the safety valve fitted.
- **DO NOT** tamper with the safety valve, **DO NOT** modify or alter the bead seater in any way and **DO NOT** strap anything to it.
- **DO NOT** subject the bead seater to impact, vibration or heat and **DO NOT** allow contact with abrasives or **corrosives**.
- Drain condensation from bead seater daily, inspect inside walls for corrosion every three months and have a detailed inspection carried out annually.
- The bead seater shell must not fall below the certified thickness at any point.



● **INTRODUCTION**

The easy and instant way to seat tubeless tyre beads. Dumps air into tyre void forcing bead to seat against rim for inflation. Fully certified tank with gauge and safety valve prevents over pressurising. Suitable for use on cars, commercials, agricultural and ATV tyres.

● **SPECIFICATION**

Weight 15 kg (33.1 lbs)
 Capacity 5 gallon (22ltr)
 Max. Pressure 10bar / 145psi

- Step 1. To check the pressure when inflating
 (set the pressure within the standard), less than make up
- Step 2. Start using the high pressure bucket to fill the air pressure into the tire

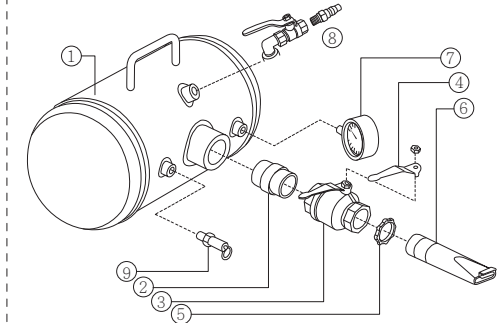
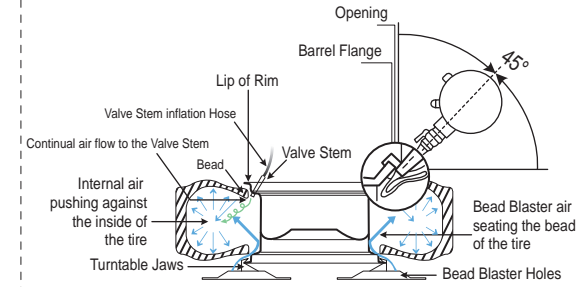
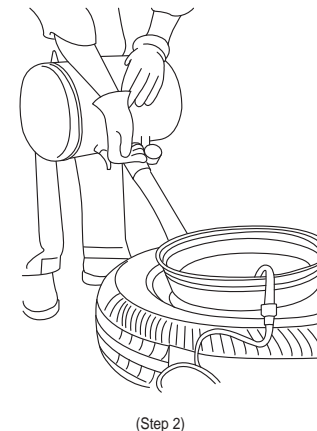
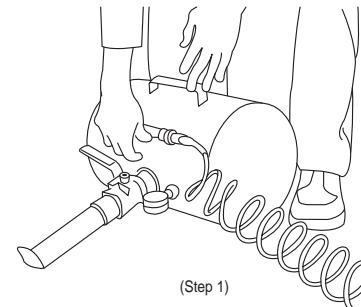

NO.	DESCRIPTION	REQ'D NO.
1	Air Tank	1
2	Pip Nipple	1
3	Air Discharge Valve	1
4	Air Discharge Valve Handle and Nut only	1
5	Lock Nut	1
6	Threaded Barrel	1
7	300psi Pressure Gauge	1
8	Air Intake Ball Valve	1
9	Safety Release Valve	1

