

## Intelligent battery clamp specifications



### Step 1.

Connect the clamps to car battery, red to "+", black to "-".

### Step 2.

Connect with jump starter.

### Step 3.

Confirm the jump starter is ready to use by checking the indicator light.

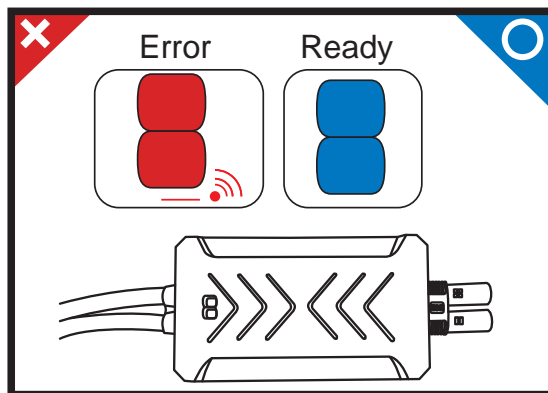

## Functions of intelligent battery clamp:

Function	Indication	Details Description
Standby	RED light	The clamp and jump starter are connected but without connection with car battery. It changes to blue light after connecting to car battery.
Automatic Power off		When blue light is on, if the car hasn't been started after 30s, the output will be shut off.
Low Voltage Protection		When jump starter's voltage $V_{BAT} < 10.5V$ , the clamp will be in <b>Low Voltage Protection mode</b> , the output will be shut off.
Reverse Polarity Protection	RED light & buzzer	When the clamps are reversely connected to the car battery, the battery clamp will be in <b>Reverse Polarity Protection mode</b> , the output will be shut off.
Short Circuit Protection		When the two clamps are connected, the battery clamp will be in <b>Short Circuit Protection mode</b> , the output will be shut off.
Reverse Charging Protection		If there is any reverse current, the output will be shut off.

  
**KING TONY**

# MULTI-FUNCTION JUMP STARTER

**16000mAh**

**No.9DS11-16**



Enjoy your work

## Instructions:

### • Charging the device

Insert the adapter into 12V / 15V charge port or in-car charger.

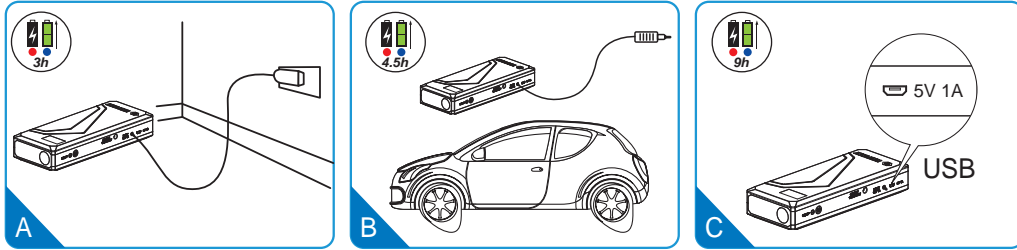

## Instructions for use :

### • 12V vehicle starting

Power

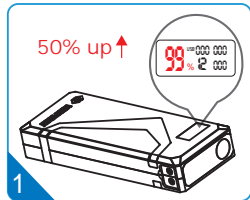

Connect

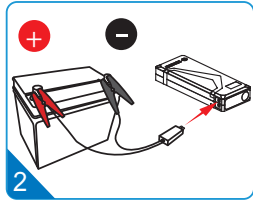

Start

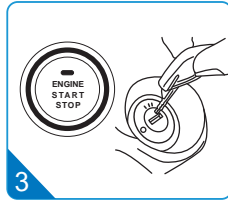

Remove

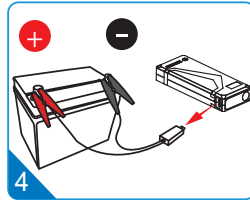

### • Charging 5V digital products

Choose the correct intelligent charge cable.

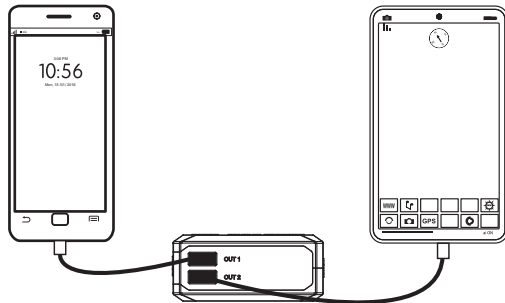

3

## Multi-Function Jump Starter Manual

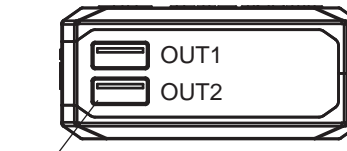

5V output port

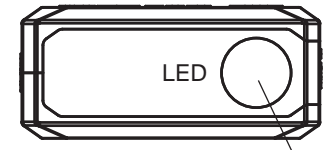

LED flashlight

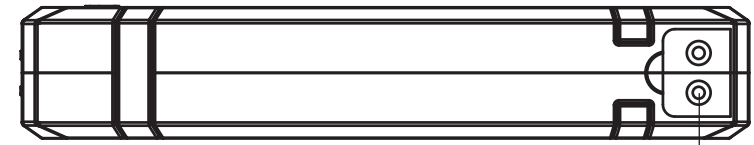

12V auto automatic port

Power / LED Switch

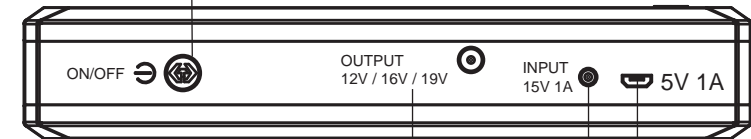

19V / 16V / 12V intelligent output port

USB charge port

15V charge port

Power

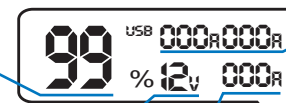





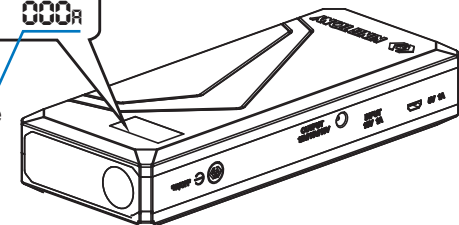

output voltage  
Laptop output voltage

USB output voltage





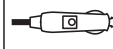
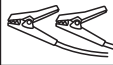









2

## Accessory List:

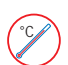
No.	1	2	3	4	5	6	7
Contents	Main device 	USB charging cable 	Device charging cable 	12V charger 	In-car charger 	Storage battery clamps 	Instruction manual 
Quantity	1	1	1	1	1	1	1



### WARNING

-  Do not use the product in bathroom or other damp places or places near the water.
-  Do not remodel or dismantle the device.
-  Keep the product away from the children.
-  Do not hit or throw the product.
-  Keep the product away from fire.
-  Do not charge the device with higher voltage.
-  The temperature should be kept between 0° C to 40° C when the device is being charged.
-  Do not reverse the connection's output or input.
-  Keep the product away from the flammable objects (Bed or carpet)
-  If the liquid of the devices is splashed into eyes, do not wipe the eyes but wash them with clean water immediately.
-  If the product is heating and discolouring, please stop using, as it may lead to liquid, smoke and burn.
-  After long term storage or not in use, please ensure that devices will be charged and discharged in every three months.

## • Charging a 12V /16V / 19V devices

- Voltage will be shown on the monitor of jump starter. The preset voltage is 12V.
- The 12V will flash for 3 seconds after turning on. Briefly press the power switch to change voltage according to different devices within the 3 seconds.

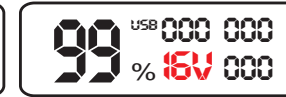
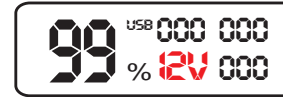

- Please restart the jump starter if you need to change voltage after the 3 seconds.

*Example :* charging a 19V laptop

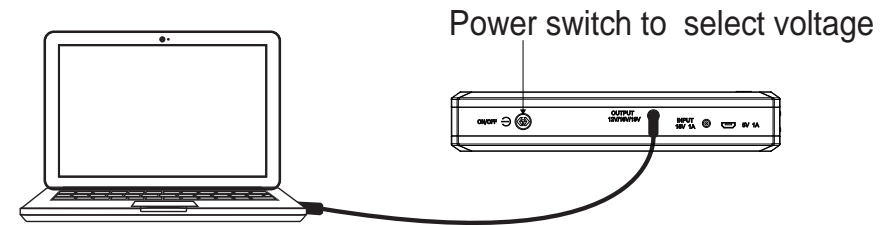

## • Turn on the LED emergency light

Hold switch 3S  
turn on



Briefly press  
SOS mode



Press again  
strobe light mode

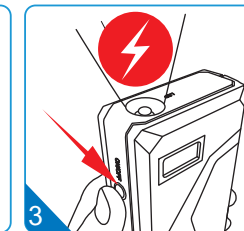

Press again  
turn off

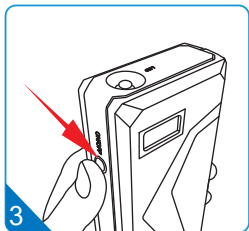

### Automatic power off

The power will be shut off if there is no output after 15 seconds.



www.kingtony.com  
customer service e-mail : service@kingtony.com

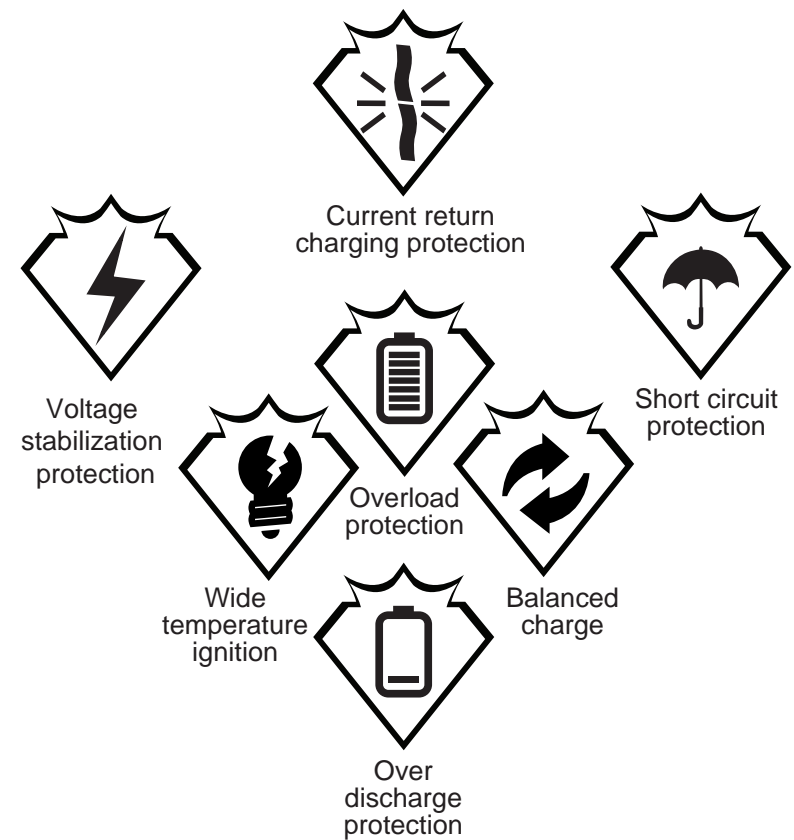

**ROHS**

**CE**

**FC**

